

NKB-TYPE

※ Center for heavy duty and Semi High Speed

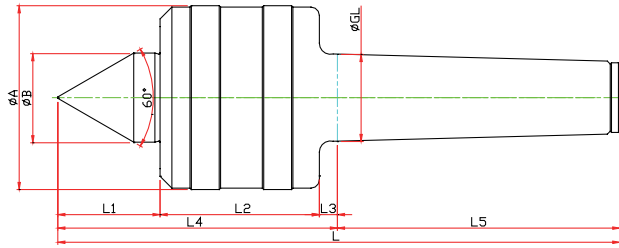

unit:mm/kg

Model	Morse Taper	Dimension										Weight Max. (lbs)	R.P.M Max.	Run out (inch)
		GL	A	B	L1	L2	L3	L4	L5	L				
LC-3NK	NO.3	23,825	52	22	29	42	5	76	80	156	4188,78	5000	0,00011811	
LC-4NK	NO.4	31,267	66	32	37	57	6,5	100,5	101,5	202	5952,48	3800	0,00011811	
LC-5NK	NO.5	44,399	80	40	45,5	57	6,5	109	129,5	238,5	7054,79	3400	0,00019685	
LC-6NK	NO.6	63,348	132	65	65	100	8	173	182	355	22046,23	1800	0,00019685	
LC-7NK	NO.7	83,058	168	72	84	128	10	222	250	427	37919,52	1200	0,00019685	

※SPECIAL sizes or dimensions are available with quick turnaround

NKB-TYPE

※ SHAFT EXTENTION(Minimize the bite-interference)

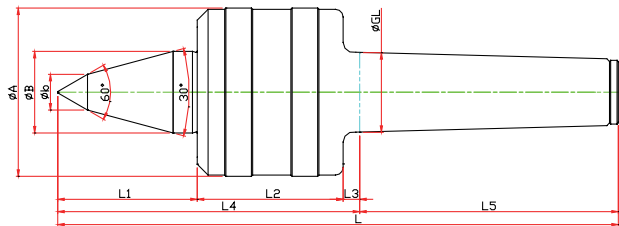

unit:mm/kg

Model	Morse Taper	Dimension										Weight Max. (lbs)	R.P.M Max.	Run out (inch)
		GL	A	B	b	L1	L2	L3	L4	L5	L			
LC-3NKB	NO.3	23,825	52	22	10	48	42	5	95	80	175	4188,78	5000	0,00011811
LC-4NKB	NO.4	31,267	66	32	14	53	57	6,5	116,5	101,5	218	5952,48	3800	0,00011811
LC-5NKB	NO.5	44,399	80	40	18	65,5	57	6,5	129	129,5	258,5	7054,79	3400	0,00019685
LC-6NKB	NO.6	63,348	132	65	25	78	100	8	186	182	368	22046,23	1800	0,00019685

※SPECIAL sizes or dimensions are available with quick turnaround

NKC-TYPE

※ Carbide Type

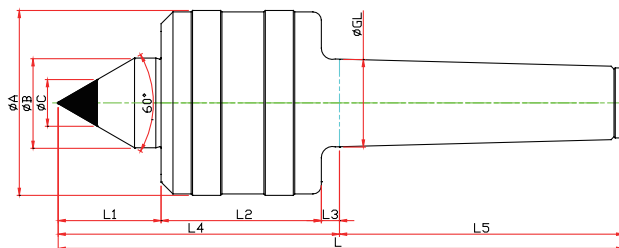

unit:mm/kg

Model	Morse Taper	Dimension										Weight Max. (lbs)	R.P.M Max.	Run out (inch)
		GL	A	B	L1	L2	L3	L4	L5	C	L			
LC-3NKC	NO.3	23,825	52	22	29	42	5	76	80	10	156	4188,78	5000	0,00011811
LC-4NKC	NO.4	31,267	66	32	37	57	6,5	100,5	101,5	14	202	5952,48	3800	0,00011811
LC-5NKC	NO.5	44,399	80	40	45,5	57	6,5	109	129,5	18	238,5	7054,79	3400	0,00019685
LC-6NKC	NO.6	63,348	132	65	65	100	8	173	182	25	355	22046,23	1800	0,00019685

※SPECIAL sizes or dimensions are available with quick turnaround